

EXISTING SITE

The Surrounding Area

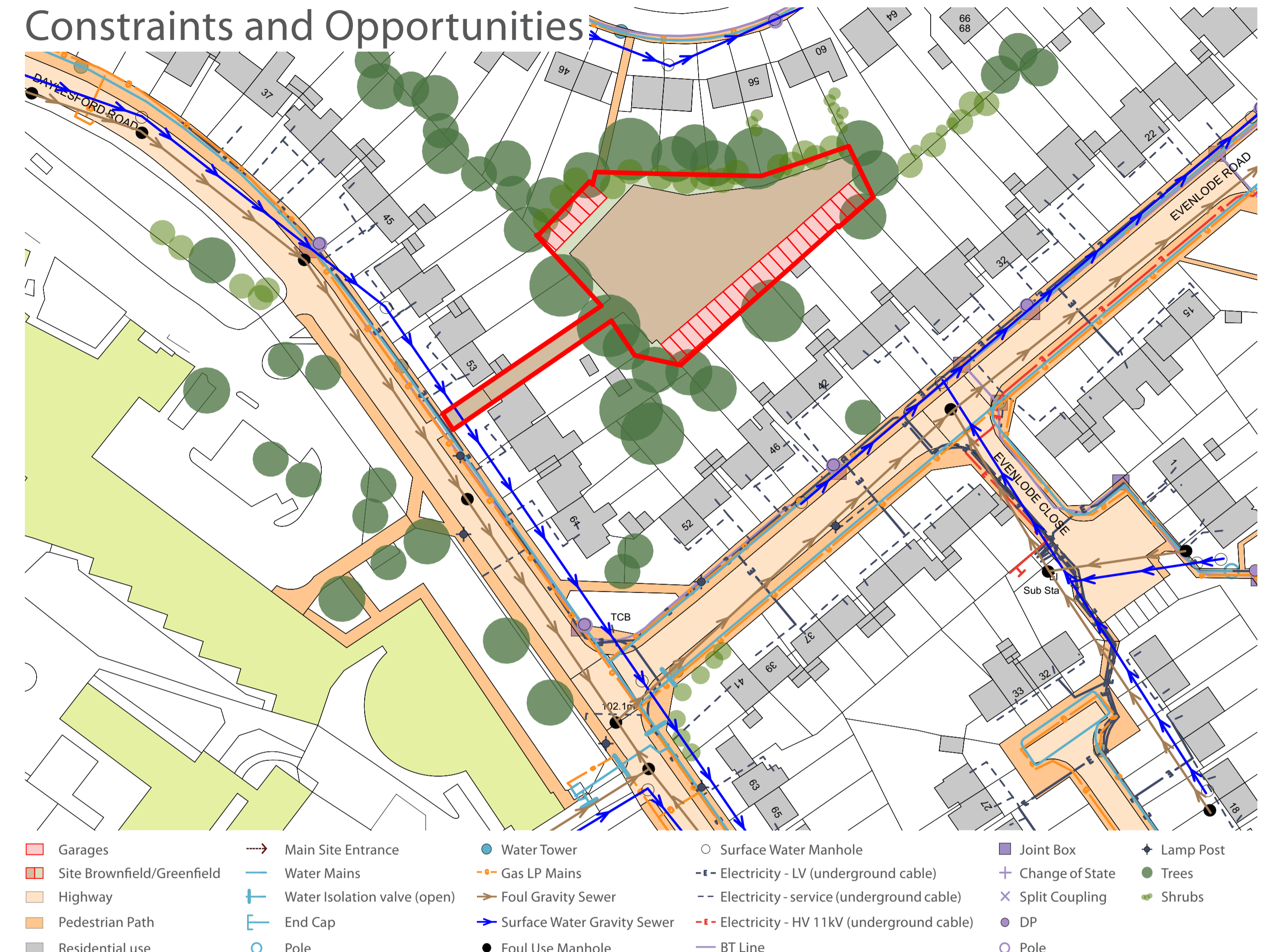

Constraints and Opportunities



The Site

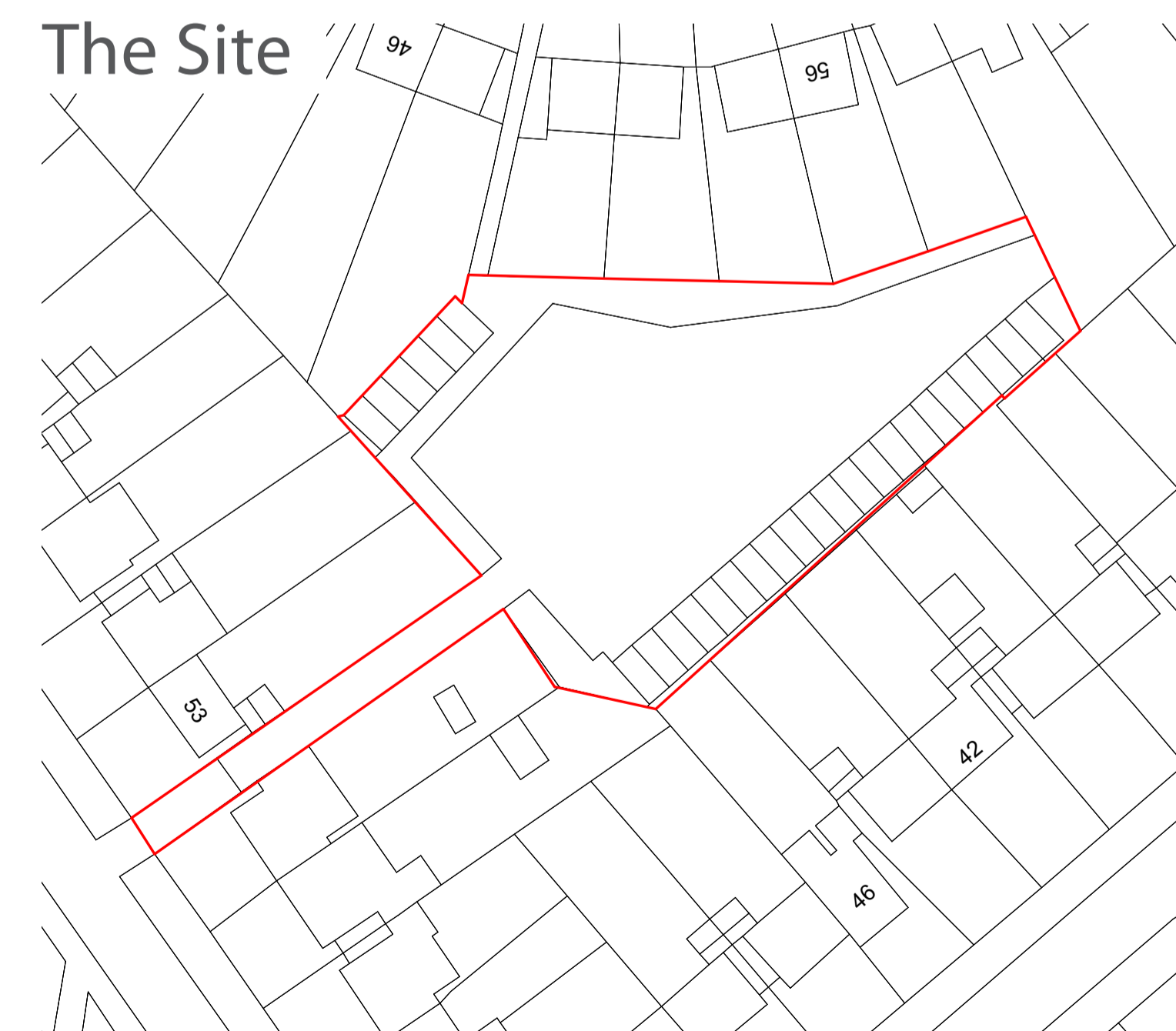

rg+p Ltd is preparing a planning application on land off Daylesford Road, Solihull. The proposal is for 9 houses, comprising a mix of 2 and 3 bedroom types. The application is being prepared on behalf of **Solihull Community Housing**.

PROPOSED SITE

The proposed scheme aims to provide high quality, energy efficient housing to meet the local need, with a material palette and style to enhance the local surroundings. The scheme will provide on plot parking, private garden areas and a safe environment for residents and visitors.

Draft Site Layout

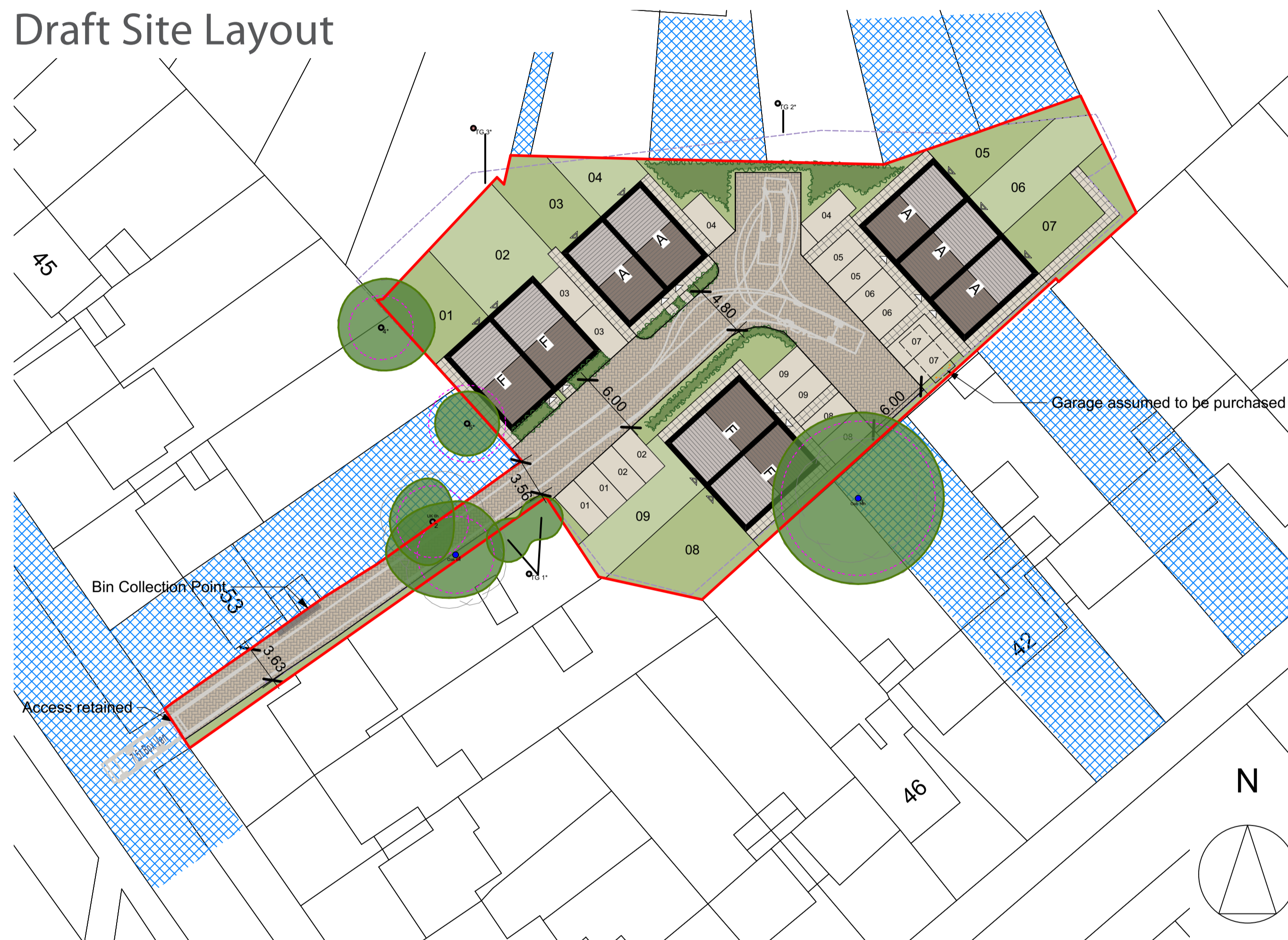

Before the proposal is finalised we want to hear from the local community. This exhibition invites your comments and suggestions, which will be carefully considered in preparation of the planning application.

Proposed Plans and Elevations:

